

SIGNATURE

NORTH EAST

OFFICIALLY RATED THE NO.1 ESTATE AGENT IN THE NORTH EAST





📍 Drummond Terrace, North Shields NE30 2AF

Drummond Terrace, North Shields NE30 2AF

Offers Over £260,000

Signature North East welcomes you to this charming three-bedroom terraced home, ideally located in North Shields and offered with no onward chain. The property enjoys a convenient position with a range of local amenities close by, as well as Long Sands beach and the vibrant North Shields Fish Quay just a short distance away. Excellent transport links are easily accessible, with the Coast Road and North Shields Metro offering direct routes across the region.

Upon entering, you are greeted by a welcoming hallway that leads into the bright and spacious living room, complete with a large bay window, decorative fireplace, and ample space for your desired furnishings. Next, step into the generously sized dining room, an ideal space for entertaining guests, featuring built-in storage cupboards for added convenience. The kitchen is fitted with a range of wall and base units and countertops, and provides access to the rear garden.

To the first floor, the home offers three bedrooms, two of which are well-proportioned doubles, providing plenty of space to personalise to your taste. Completing this level is the family bathroom, fitted with a walk-in shower, wash basin, and WC. Continuing to the second floor, you'll find a spacious loft room, offering additional versatility for use as an office, hobby room, or guest space.

Externally, the property benefits from a well-sized rear garden, perfect for outdoor seating or family enjoyment. Parking is available on street, adding to the home's practicality and appeal. This delightful property presents an excellent opportunity for a range of buyers seeking a well-located home close to the coast.



PLEASE NOTE THAT THE VENDOR HAS CERTIFIED THE PROPERTY INFORMATION AND IMAGES.

PROPERTY FLOORPLAN

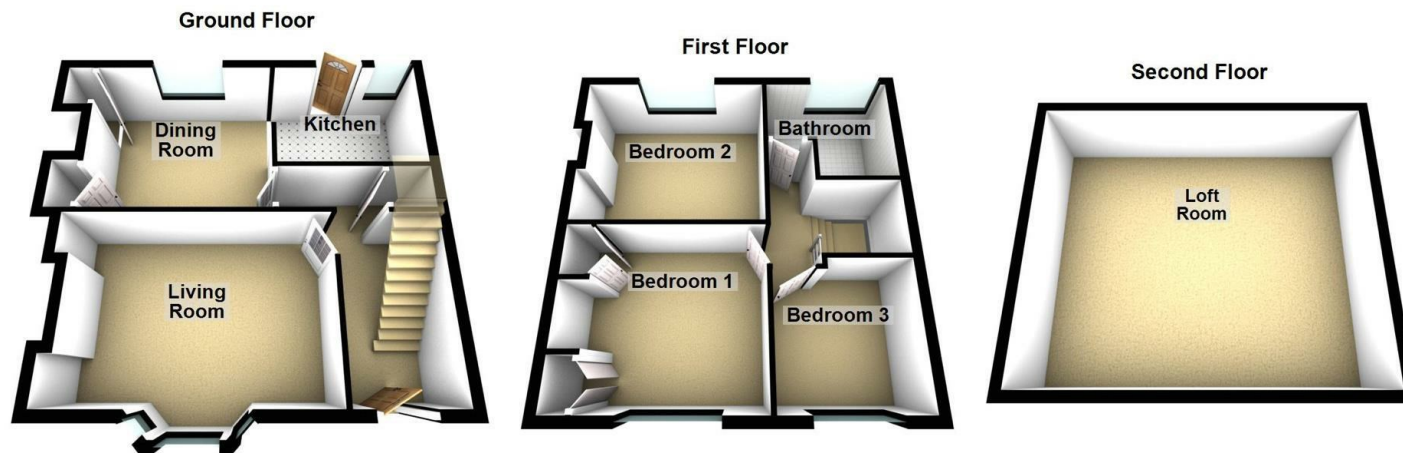

Total area: approx. 124.0 sq. metres (1335.1 sq. feet)

Measurements:

Living Room
10'11" x 16'1"

Dining Room
10'7" x 11'10"

Kitchen
7'5" x 8'7"

Bedroom One
10'11" x 10'6"

Bedroom Two
10'9" x 12'4"

Bedroom Three
8'6" x 8'9"

Bathroom
8'7" x 7'7"

Loft Room
17'10" x 21'5"

Energy Efficiency Rating

	Current	Potential
Very energy efficient - lower running costs		
(92 plus) A		
(81-91) B		
(69-80) C		79
(55-68) D	67	
(39-54) E		
(21-38) F		
(1-20) G		
Not energy efficient - higher running costs		
England & Wales EU Directive 2002/91/EC		





More 5 Star Customer Reviews than any other Agent based in the North East on [allAgents.co.uk](https://allagents.co.uk)



SALES

LETTINGS

FINANCE

LAW

WE COVER THE WHOLE OF THE NORTH EAST

Whitley Bay
0191 251 3344

Cramlington
01670 897 213

Tynemouth
0191 296 6689

Morpeth
01670 513 966

Ponteland
01661 820 082

Wallsend
0191 432 4151

Alnwick
01665 511 800

Heaton
0191 432 4275

Forest Hall
0191 266 9966

Other locations
0191 640 3523

Newcastle
0191 640 2284

Durham
0191 303 8252

Gosforth
0191 640 3523

Sunderland
0191 543 6390

Whickham
0191 432 5102

Gateshead
0191 432 4294

Jesmond
0191 281 1037

Killingworth
0191 640 3602

Ryton
0191 413 9845

Head Office &
Lettings
0191 253 4815

*Highest recommended 5-star reviews than any other Estate Agent based in the North East on [allAgents.co.uk](https://allagents.co.uk) - The UK's Largest Customer Review Website for the Property Industry & Awarded Best Estate Agency 2018 & 2019 - North East England by SME News